

VERTICAL P.C.B.

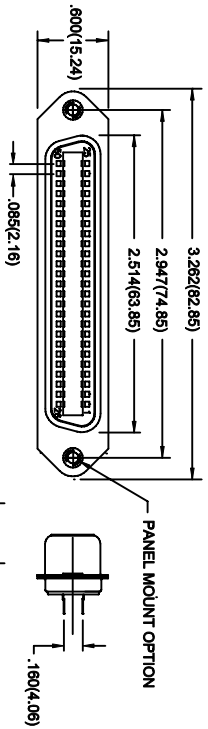

VERTICAL PRESS FIT

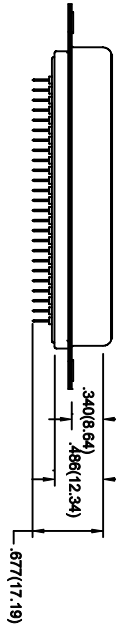

PANEL MOUNT OPTION

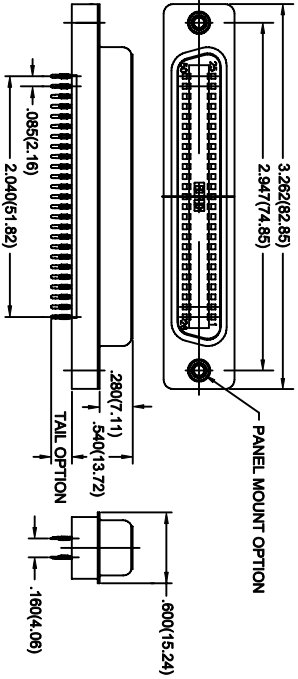

RIGHT ANGLE P.C.B.

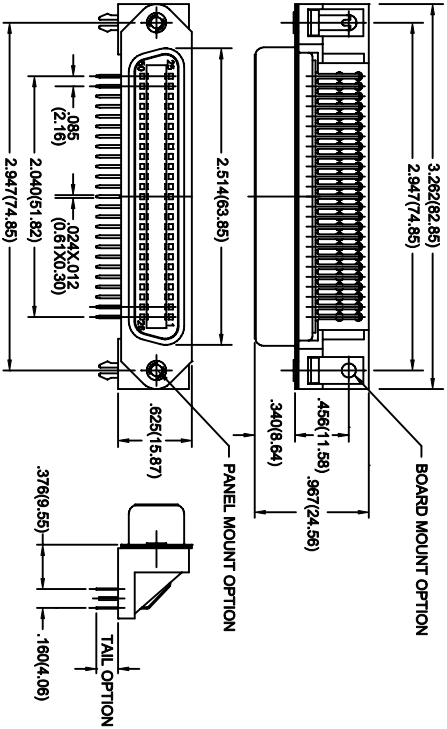

B57-150-260-202

THIS IS A C.A.D. GENERATED DRAWING
DO NOT MAKE MANUAL REVISIONS TO MASTER.

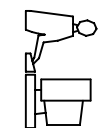

ISSUE NUMBER
ORIGINAL

1

- SERIES**
- 0-RECEPTACLE
 - 1-PLUG
- NO. OF CONTACTS**
50 OR 64
- CONTACT FINISH**
- 2-GOLD FLASH, GOLD PLATED
(2 MICRONS MIN. THICKNESS)
 - 5-15U" GOLD
 - 6-30U" GOLD
- 20- VERTICAL PRESS FIT
 - 21- VERTICAL PCB
 - 29- FLAT CABLE TERMINATION
 - 60- RIGHT ANGLE PCB(.187 TAIL LG.)
 - 61- RIGHT ANGLE PCB(.100 TAIL LG.)
 - 62- RIGHT ANGLE PCB(.125 TAIL LG.)
- A- 4-40 STANDOFF ON POS. 1 AND
JHOOK ON POSITION 25
 - 2- 4-40 THREADED INSERT/.120 DIA. HOLE
 - 3- 4-40 THREADED INSERT/4-40 THREADED HOLE
 - 4- .120 DIA HOLE/.120 DIA HOLE
 - 5- 4-40 THREADED INSERT/BOARDLOCKS
 - 6- 4-40 THREADED INSERT/BOARDLOCKS/LATCH
 - 7- .120 DIA. INSERT/4-40 THREADED HOLE
 - 8- 4-40 HEX STANDOFF/BOARDLOCKS
(THE ABOVE HOLES PANEL MOUNT FIRST)

- MATERIALS:**
- INSULATOR: GLASS-FILLED THERMOPLASTIC
UL RATED 94V-0, COLOR BLUE
 - CONTACT: COPPER ALLOY
PHOSPHOR BRONZE (PRESS FIT)
GOLD PLATED ON CONTACT AREA, TIN ON TAIL
OVER NICKEL
 - 260- GOLD FLASH(2 MICRONS MIN. THICKNESS)
 - 560- 15 MICRONS OF GOLD
 - 660- 30 MICRONS OF GOLD
- SHELL : STEEL NICKEL PLATED**
- ELECTRICALS:**
- CONTACT CURRENT RATING: 5 AC/DC AMPS CONTINUOUS
 - CONNECTOR IS NOT "HOT SWAPPABLE"
 - DIELECTRIC WITHSTANDING VOLTAGE: 1200 VAC RMS
 - INSULATOR RESISTANCE: 1000 mohms MIN. AT 500V DC
 - OPERATING VOLTAGE 250 VAC
 - CONTACT RESISTANCE: 30 MOHMS MAXIMUM
 - OPERATING TEMPERATURE: -55 C TO +105 C



THIS SERIES FULLY CONFORMS TO THE
EUROPEAN UNION DIRECTIVES 2002/95/EC
AND 2002/96/EC FOR ROHS COMPLIANCY.

**50 POSITIONS MINIATURE RIBBON CONNECTOR
GENERIC DWG.**

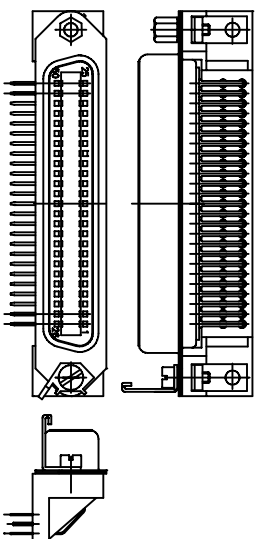

RIGHT ANGLE CONNECTOR WITH J-HOOK DEVICE

EDAC INC
TORONTO, ONTARIO
CANADA

THESE DRAWINGS AND SPECIFICATIONS
ARE THE PROPERTY OF EDAC INC. AND
SHALL NOT BE REPRODUCED, COPIED
OR USED AS THE BASIS FOR THE
MANUFACTURE OR SALE OF APPARATUS
WITHOUT WRITTEN PERMISSION.

ACAD REFERENCE NO.	B57 GENERIC DWG.
DRAWN: F.BRIONES	DATE: JUN.28/05
PART NUMBER	SEE ABOVE
DRAWING NUMBER	B57 GENERIC DWG.
ISSUE	1